

OKASOLAR - REFERENCES

Germany | Ingolstadt | Audi Electronics Centre

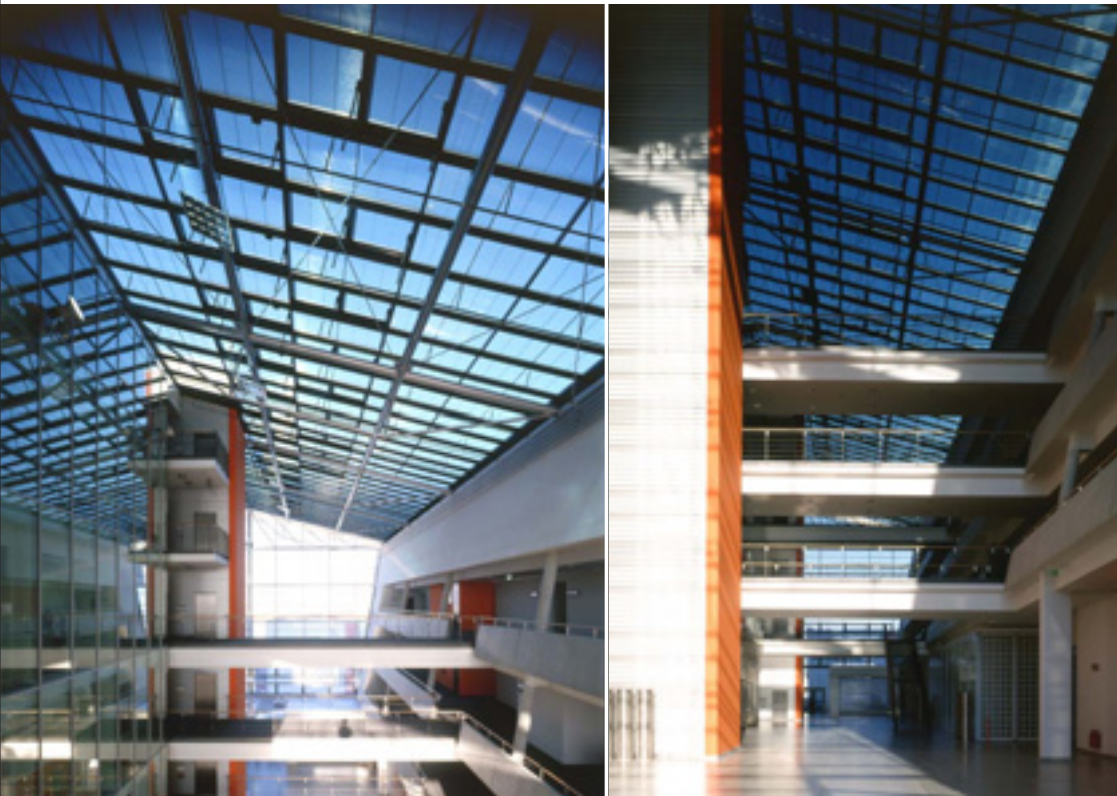

Project:
Audi Electronics Centre
Location:
Ingolstadt, Germany
Product:
OKASOLAR-S
Square metres:
1058 m²
Special features:
Revealing insights
Architect:
RKW Architektur + Städtebau,
Düsseldorf
Execution:
G+H Fassadentechnik GmbH,
Karlsruhe
Completion:
2003

The think tank that offers revealing insights. The Audi Electronics Centre in Ingolstadt demonstrates the direct spatial link between the automobile world and the office world. Thinkers and craftsmen work wall to wall with a view from window to window on a road spanned by bridges where cars continually drive past. Deeply incised light wells, terraces and cascaded offices give the impression of a labyrinth of knowledge in which people not only sit and think but also drill and bolt and hammer. In the car of the future, many innovations are influenced by electronics <ETH> and innovations are created to a great extent through face-to-face communication. The architecture by RKW Architects follows this fundamental idea.

The spatial arrangement of the workplaces corresponds to the meshwork of the relations between system developers, sales consultants and workshop staff. This creates many opportunities for an informal, constructive exchange of ideas. In Audi's creative high-tech workshops, great importance is attached to the intensive utilisation of daylight. The approx. 1,000 square metre glass lean-to roof with an integrated light deflecting system makes an important contribution here. Metallised aluminium profiles in the cavities of the OKASOLAR-S insulating glass panes act as solar protectors to reflect the direct sunlight. At the same time they deflect diffuse sky light deep into the rooms, creating a pleasant working atmosphere.



We take architectural glass a step ahead.